



863a Princes Highway Springvale VIC

Crabtrees Real Estate are pleased to offer 863a Princes Highway, Springvale for Lease.

This open plan showroom/warehouse is ideally positioned close to Springvale Road, Police Road and EastLink.

Key Features:

- + High profile position next door to new Bunnings Warehouse
- + Retail showroom and warehouse of 725 to 1,700 sqm approximately
- + Excellent opportunity within rapidly developing showroom precinct
- + Large on site customer car park front and rear
- + Kitchenette and toilets amenities
- + Close to Springvale Homemaker Centre
- + Wide rear roller door access

Price : CONTACT AGENT
Building Size : 725 sqm
View : <https://www.crabtrees.com.au/lease/vic/south-east/springvale/commercial/showroomsbulky-goods/6492873>



Saul Akoka
(03) 95678888



Joe Monea
(03) 95678888

<https://www.crabtrees.com.au>

Crabtrees Real Estate is built on history, reputation and expertise. We offer a level of knowledge others can't match.

Unit 4, 861-865 Princess Hwy, Springvale

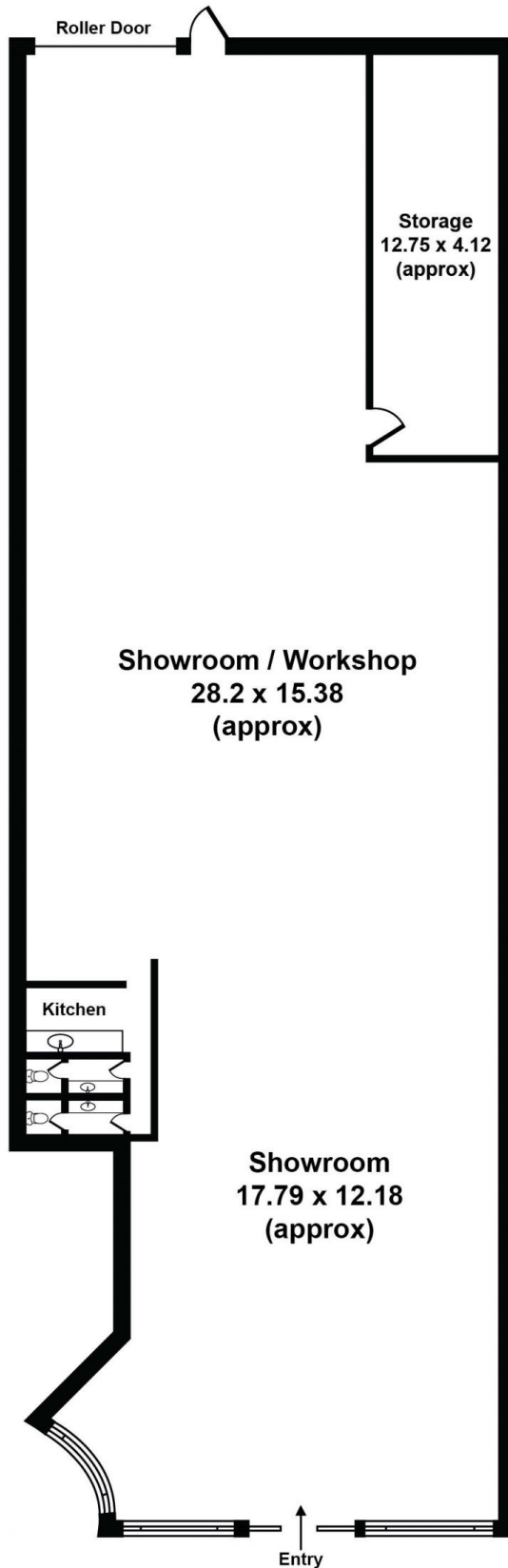

Total Area = 725sqm
(approx)

Whilst every attempt has been made to ensure the accuracy of this floorplan, measurements of doors, windows, rooms and any other items are approximates only. The producer or agent cannot be held responsible for any errors, omissions or misstatements. This plan is for illustrative purposes only and should be used as such.